

GLASTONBURY

Note: The Q100 CC Flood Line plotted herein is from Gympie Regional Council Data. The 1% AEP Climate Change Developed Flood Line is RL 61.91m AHD.

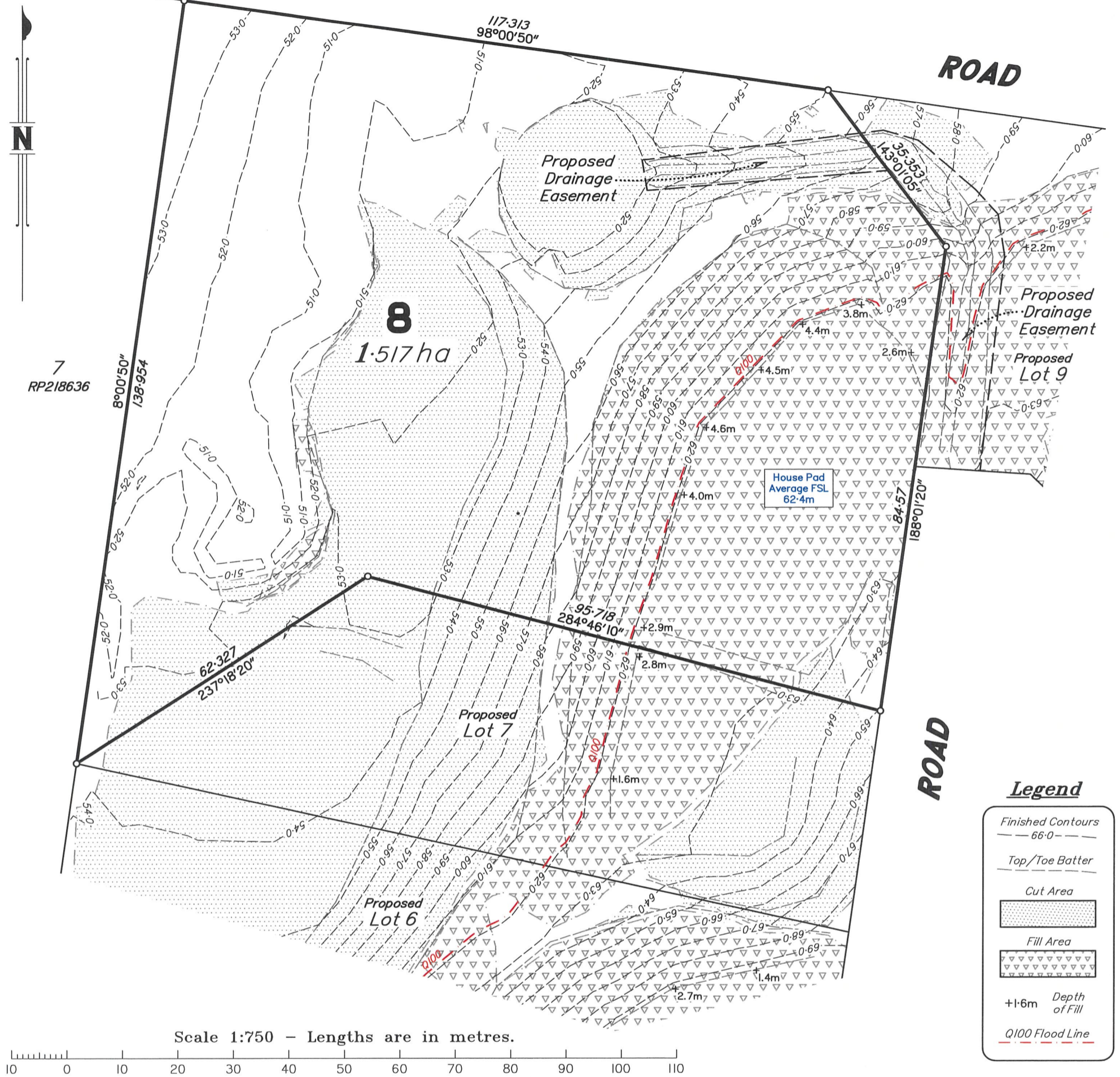

Scale 1:750 - Lengths are in metres.

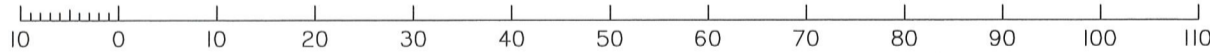

Certification of Proposed Allotment 8 Details

This plan illustrates Proposed Lot 8 as approved by Gympie Regional Council Development Approval file: 2017-0999, dated 20/06/2022, for Reconfiguration of a Lot, and in accordance with Operational Works Permit No. 2023-1995 dated 8/09/2023 and Haynes Consulting Engineers Drawings Series No.2103-S15 and subsequent sheets and amendments as approved by Gympie Regional Council.

Notes

1. Contours shown are actual Finished Surface levels derived from Detail Survey by Murray & Associates as at 4/02/2025 and are shown at 1.0m intervals. Contours are not suitable for building design purposes.
2. All areas and dimensions are subject to council sealing of the Survey Plan and registration in the Department of Natural Resources and Mines, Manufacturing and Regional and Rural Development.
3. This Plan is to be used as an attachment under the Land Sales Act 1984 to sell Freehold Land off the Plan.
4. All dimensions and areas are subject to final registration of the Survey Plan.
5. Compaction of any fill material placed on this site shall be completed under inspection and testing services in accordance with AS3798-2007.
6. Proposed Lot 8 is to be encumbered by an Easement for Drainage purposes.

MURRAY & ASSOCIATES
SURVEYORS & TOWN PLANNERS
ACN 075 543 154
Murray Building, 15-17 Currie St. Nambour Ph.(07)5441 2188 P.O. Box 246
Branch Offices at Caboolture Chinchilla Roma Gympie & Emerald
CADASTRAL SURVEYOR

DISCLOSURE PLAN
Disclosure Plan for Proposed Lot 8
(Currently part of Lot 8 on RP218636)

LOCAL AUTHORITY: GYMPIE REGIONAL COUNCIL LOCALITY: Nahrunda

CLIENT: **Roberts Bros**

DATE: 19/02/2025 SCALE: 1:750
COMP FILE: 100490_(Disclosure)_Roberts Bros.dwg Level Datum: AHD Der vide OPM 99270
MAP REF: 9445-43212 ORIGINAL: POR 15
CONTOUR INT: 1m
DRAWN: AJH JOB No: 100490/8
CHECKED: IKS

9.1.5* 25-2-25