

Note: The Q100 CC Flood Line plotted herein is from Gympie Regional Council Data. The 1% AEP Climate Change Developed Flood Line is RL 61.91m AHD.

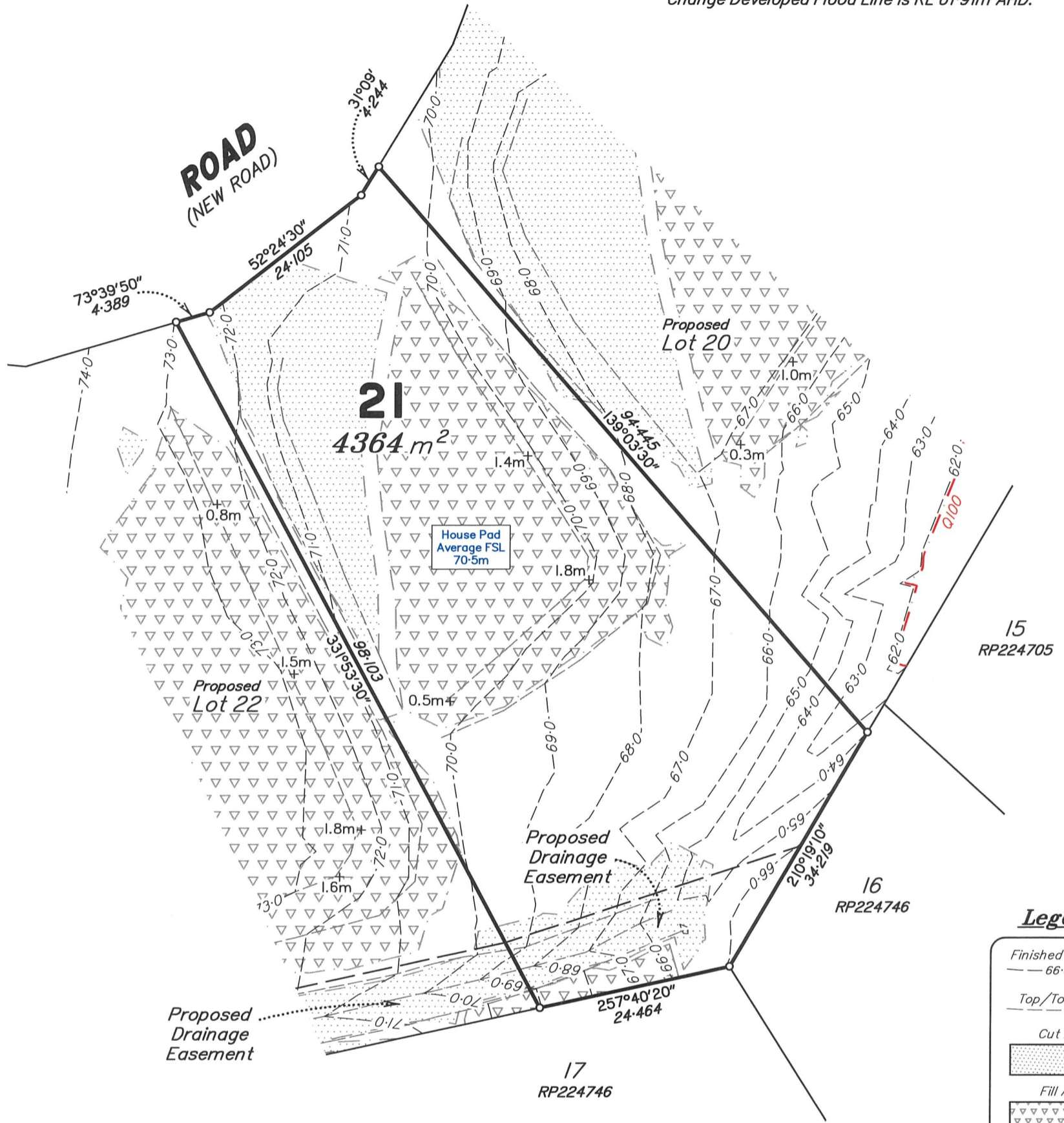

Scale 1:600 - Lengths are in metres.

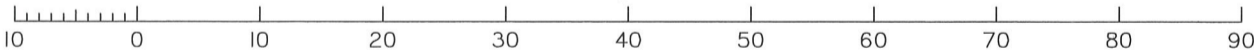

Legend

- Finished Contours 66.0
- Top/Toe Batter
- Cut Area
- Fill Area
- +1.6m Depth of Fill
- Q100 Flood Line

Certification of Proposed Allotment 21 Details

This plan illustrates Proposed Lot 21 as approved by Gympie Regional Council Development Approval file: 2017-0999, dated 20/06/2022, for Reconfiguration of a Lot, and in accordance with Operational Works Permit No. 2023-1995 dated 8/09/2023 and Haynes Consulting Engineers Drawings Series No.2103-S15 and subsequent sheets and amendments as approved by Gympie Regional Council.

Notes

1. Contours shown are actual Finished Surface levels derived from Detail Survey by Murray & Associates as at 4/02/2025 and are shown at 1.0m intervals. Contours are not suitable for building design purposes.
2. All areas and dimensions are subject to council sealing of the Survey Plan and registration in the Department of Natural Resources and Mines, Manufacturing and Regional and Rural Development.
3. This Plan is to be used as an attachment under the Land Sales Act 1984 to sell Freehold Land off the Plan.
4. All dimensions and areas are subject to final registration of the Survey Plan.
5. Compaction of any fill material placed on this site shall be completed under inspection and testing services in accordance with AS3798-2007.
6. Proposed Lot 21 is to be encumbered by an Easement for Drainage purposes.

<p>MURRAY & ASSOCIATES SURVEYORS & TOWN PLANNERS ACN 075 543 154 Murray Building, 15-17 Currie St. Nambour Ph. (07)5441 2188 P.O. Box 246 Branch Offices at Caboolture Chinchilla Roma Gympie & Emerald CADASTRAL SURVEYOR</p>	<p>DISCLOSURE PLAN Disclosure Plan for Proposed Lot 21 (Currently part of Lot 9 on RP224705)</p>	<p>CLIENT: Roberts Bros</p>
	<p>DATE: 19/02/2025 COMP FILE: 100490_(Disclosure)_Roberts Bros.dwg MAP REF: 9445-43212 CONTOUR INT: 1m DRAWN: AJH CHECKED: IKS</p>	<p>SCALE: 1:600 Level Datum: AHD Der vide OPM 99270 ORIGINAL: POR 15 JOB No: 100490/21</p>
<p>9-1.5 # 25-2-25</p>	<p>LOCAL AUTHORITY: GYMPIE REGIONAL COUNCIL LOCALITY: Nahrunda</p>	