

Note: The Q100 CC Flood Line plotted herein is from Gympie Regional Council Data. The 1% AEP Climate Change Developed Flood Line is RL 61.91m AHD.

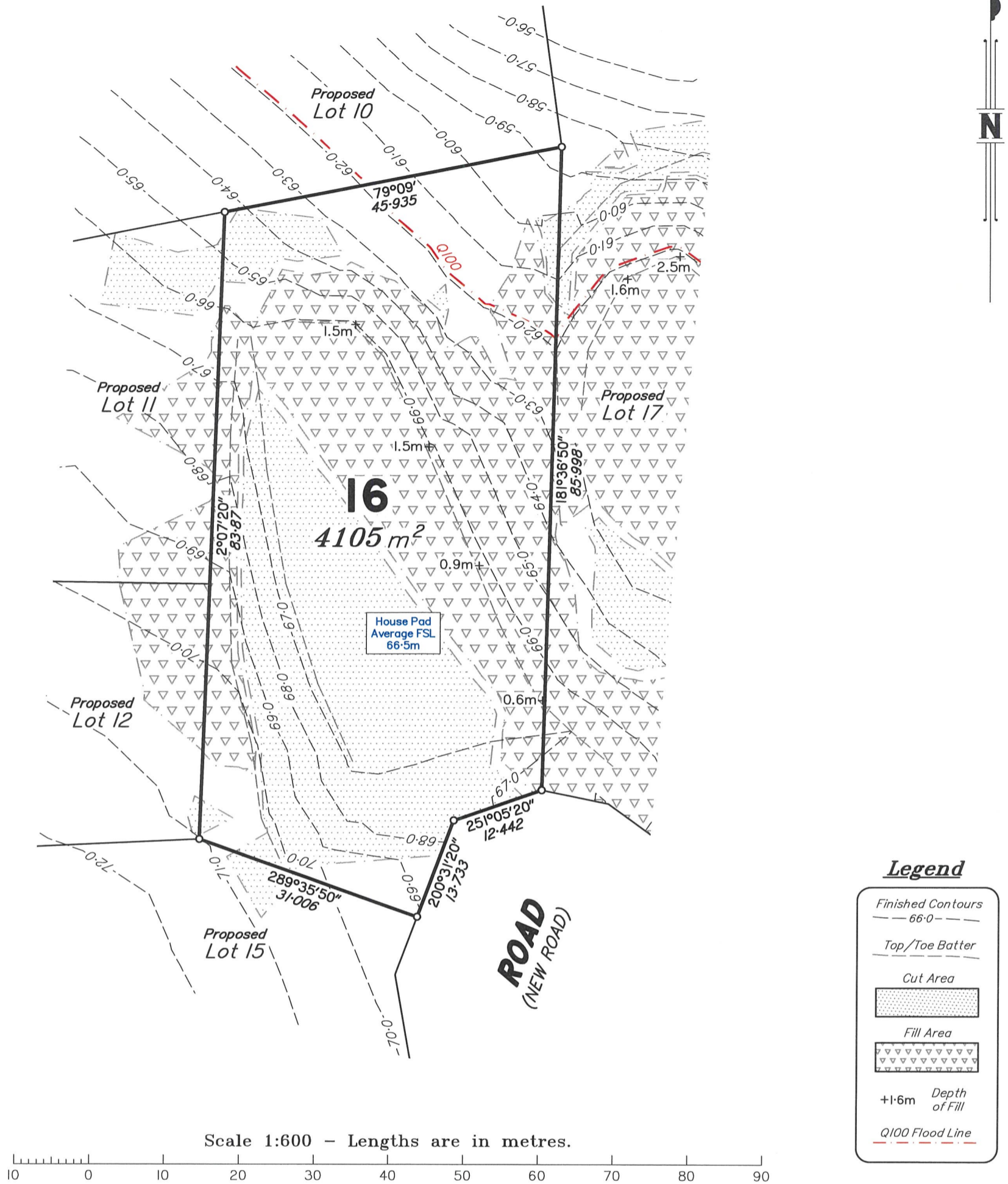

Certification of Proposed Allotment 16 Details

This plan illustrates Proposed Lot 16 as approved by Gympie Regional Council Development Approval file: 2017-0999, dated 20/06/2022, for Reconfiguration of a Lot, and in accordance with Operational Works Permit No. 2023-1995 dated 8/09/2023 and Haynes Consulting Engineers Drawings Series No.2103-S15 and subsequent sheets and amendments as approved by Gympie Regional Council.

Notes

1. Contours shown are actual Finished Surface levels derived from Detail Survey by Murray & Associates as at 4/02/2025 and are shown at 1.0m intervals. Contours are not suitable for building design purposes.
2. All areas and dimensions are subject to council sealing of the Survey Plan and registration in the Department of Natural Resources and Mines, Manufacturing and Regional and Rural Development.
3. This Plan is to be used as an attachment under the Land Sales Act 1984 to sell Freehold Land off the Plan.
4. All dimensions and areas are subject to final registration of the Survey Plan.
5. Compaction of any fill material placed on this site shall be completed under inspection and testing services in accordance with AS3798-2007.

MURRAY & ASSOCIATES SURVEYORS & TOWN PLANNERS ACN 075 543 154 Murray Building, 15-17 Currie St. Nambour Ph. (07)5441 2188 P.O. Box 246 Branch Offices at Caboolture Chinchilla Roma Gympie & Emerald CADASTRAL SURVEYOR <i>9-1.5# 25-2-25</i>	DISCLOSURE PLAN Disclosure Plan for Proposed Lot 16 (Currently part of Lot 9 on RP224705)		CLIENT: Roberts Bros	
	DATE: 19/02/2025	SCALE: 1:600	COMP FILE: 100490_(Disclosure)_Roberts Bros.dwg	Level Datum: AHD Der vide OPM 99270
	MAP REF: 9445-43212	CONTOUR INT: 1m	ORIGINAL: POR 15	JOB No: 100490/16
	DRAWN: AJH	CHECKED: IKS		
	LOCAL AUTHORITY: GYMPIE REGIONAL COUNCIL	LOCALITY: Nahrunda		